

## Scope of delivery

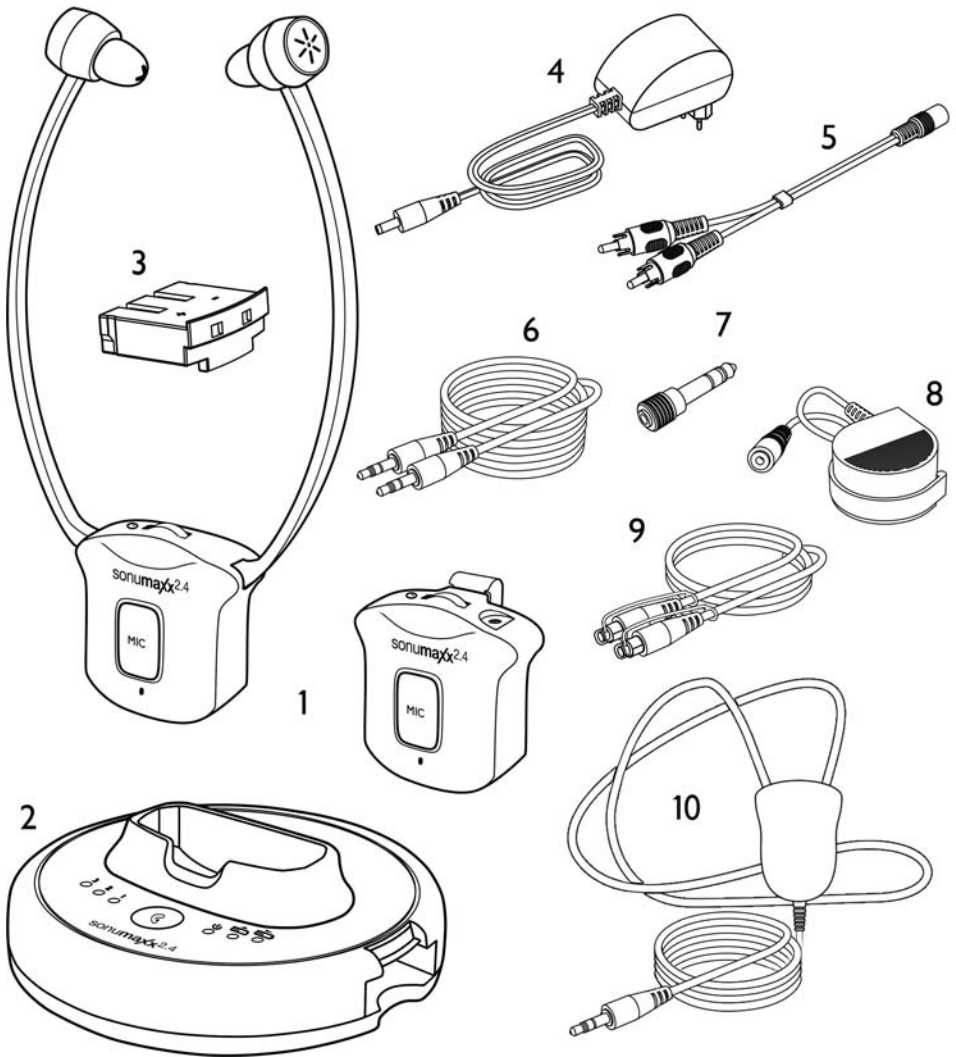

- 1 Underchin- **or** pocket receiver
- 2 Transmitter
- 3 Polymer Lithium Rechargeable Battery  
x 2 pieces
- 4 AC/DC Adapter
- 5 RCA Adapter Cable

- 6 Audio Cable (both ends with 3,5  
mm stereo plug)
- 7 6,3 mm to 3,5 mm Adapter Plug
- 8 External Microphone
- 9 TOSlink cable
- 10 neck loop
- Warranty card (not depicted)

## Controls: Receiver

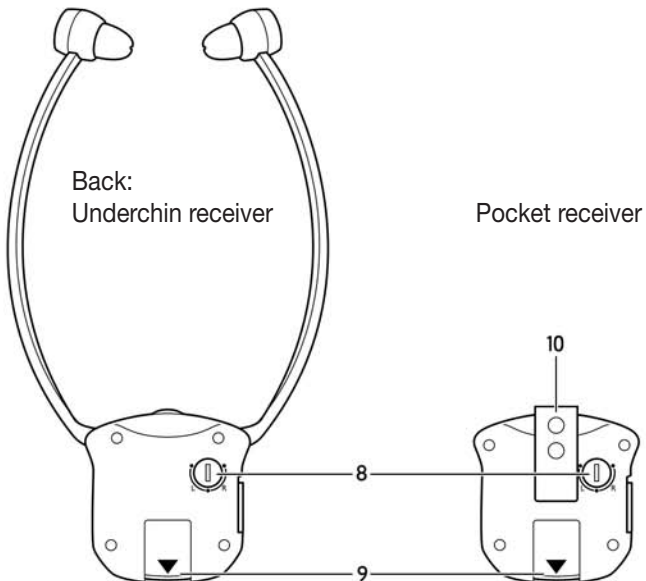
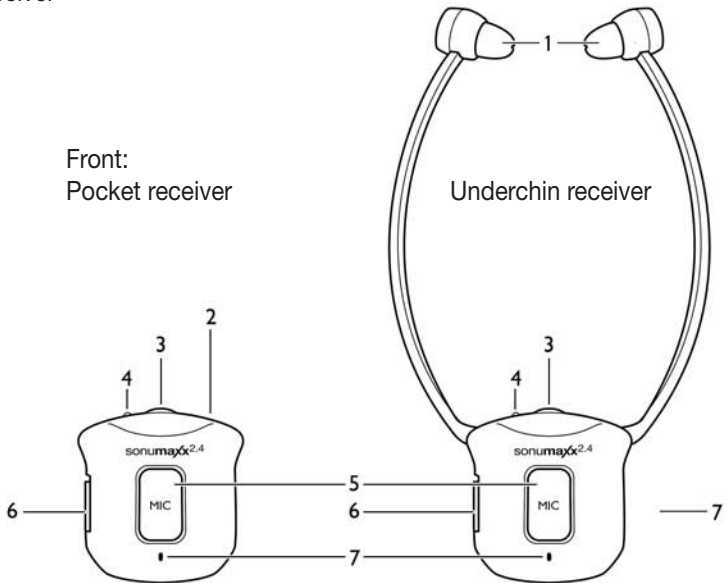

- |   |   |    |   |
|---|---|----|---|
| 1 | Adjustable Earbuds                          | 6  | Power On/Off Switch                       |
| 2 | 3,5 mm earphone jack (pocket receiver only) | 7  | Microphone                                |
| 3 | Volume Control                              | 8  | Sound Balance Control (Left/Middle/Right) |
| 4 | LED Indicator of Power/Signal               | 9  | Battery                                   |
| 5 | MIC Button for verbal communication         | 10 | Belt Clamp (pocket receiver only)         |

## Controls: Transmitter

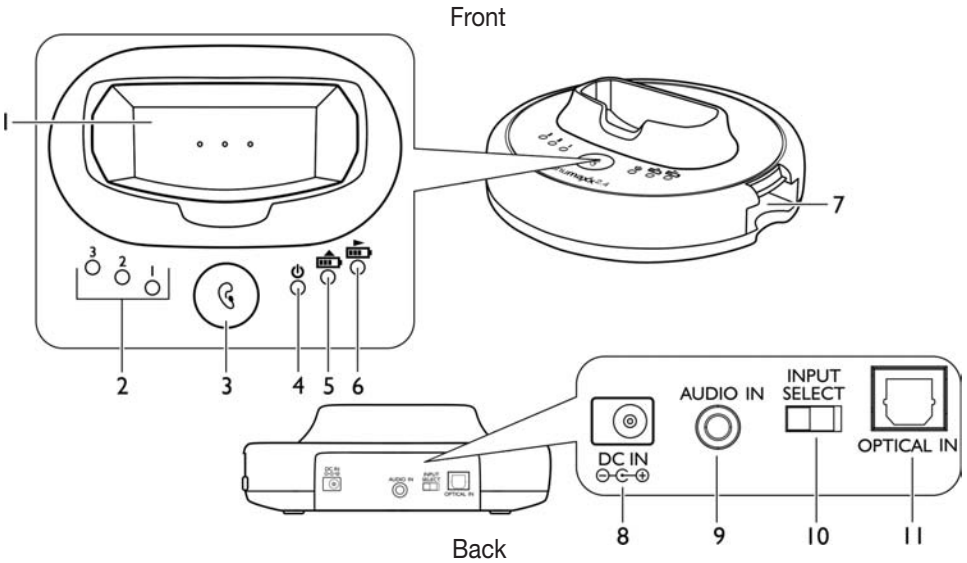

1. Charging Cradle
2. LED Indicator of Tone Clarity
3. Tone adjustment button
4. LED Indicator of Power/Signal
5. LED Charging Indicator for Main Battery (attached to Headset Receiver)
6. LED Charging Indicator for Spare Battery
7. Spare Charging Slot
8. DC In
9. 3.5mm Audio In Socket
10. Audio / Optical input selector switch
11. optical input digital

## Introduction

This 2.4GHz digital wireless chin headset uses the latest technology in digital wireless transmission and offers sound amplification.

Simply connect the transmitter to a desired audio source: DVD player, CD player, TV set, Hi-Fi system or MP3-Player. Without complicated wiring and installation, the system enables you to enjoy thrilling, lifelike sound within minutes.

## Features

- 2.4GHz Digital Hopping System Technology
- Charging bay
- Automatic shutoff, if no audio comes in
- Communication function
- Fast recharge
- Easy-to-change spare battery
- External microphone for environmental audio pickup.
- Sound balance adjustment
- Tone adjustment

## Installation: Transmitter

1. Connect the power adapter to the DC IN input socket located on the transmitter rear panel.
2. Connect the power adapter provided to an electrical outlet.
3. RCA adapter cable, audio cable, 6.3 mm to 3.5 mm adapter plug, Toslink cable and the external microphone serve to connect the transmitter to a sound source of your choice (for example DVD- or CD player, TV-set, stereo set or MP3-player).
4. Shift the input selector switch towards the accordingly connected input.

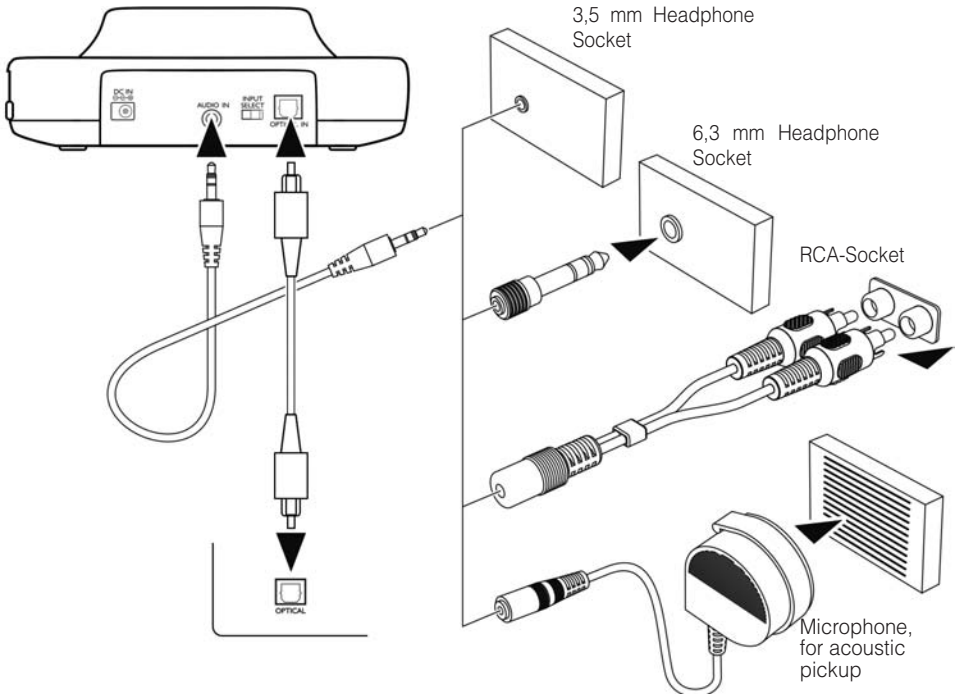

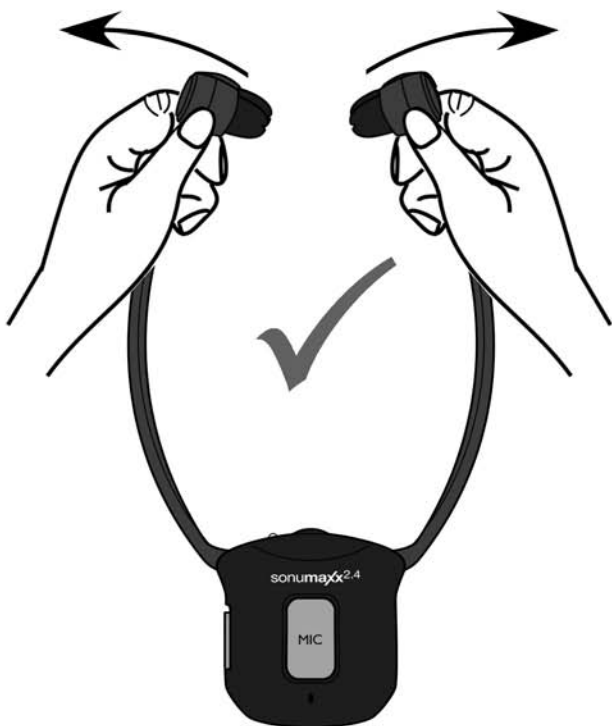

The green power indicator LED will blink as soon as you have connected the power adapter to the electrical outlet, when the audio signal is detected from the audio source, and the green LED indicator will glow constantly.

## Receiver

Insert a battery into the receiver with correct polarity.

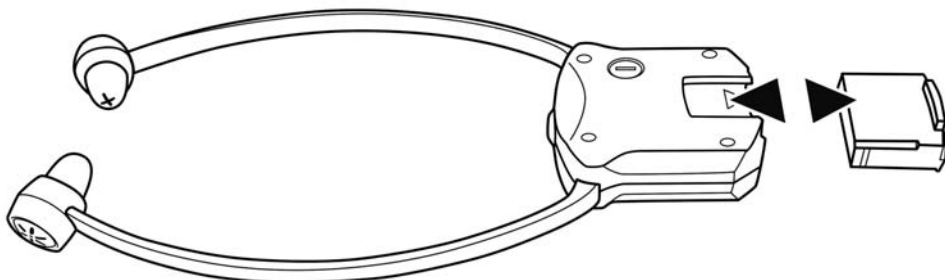

Illustration example: Underchin receiver

## Operation

1. Move the ON/OFF switch on the receiver to the OFF position.
2. Place the receiver in the charging bay of the transmitter, make sure that the contacts of receiver and transmitter touch each other.
3. The charging process starts automatically. The indicator LED for the main battery glows red. It will change to green after about 2 hours when the battery is fully charged.
4. A spare battery is provided for extended use. Simply insert it into the transmitter for charging. The indicator LED for the spare battery will change from red to green when the battery is fully charged.

The pocket receiver features a 3.5 mm audio socket, which is located on top of the device and enables the connection of the neck loop or any other regular headphones (not included).

### Note:

Make sure that the batteries included in this set are fully charged before using them for the first time. Charge the battery for about 3 hours before first use.

RF transmission of the transmitter will automatically switch OFF in approximately 5 minutes if there is no audio signal, or the signal that it receives from the audio source is too weak for proper reception. However, if the signal returns to an acceptable level, the transmitter will automatically switch ON again.

## Charging the batteries

1. Select the On/Off Switch in the headset receiver to OFF position.
2. Place the headset receiver on the transmitter, make sure the charge contact touches the charge pins on the Transmitter.
3. The charging process starts automatically. LED indicator of main battery then glows in red constantly. It will glow in green about 2 hours after the battery is fully charged.
4. A spare battery is provided for sustained enjoyment. Simply insert it into the transmitter for charging. LED indicator of spare battery will then glow in red constantly. It will glow in green about 2 hours after it is fully charged.

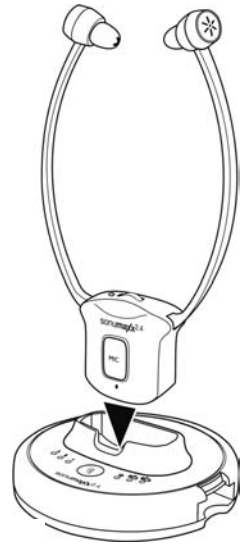
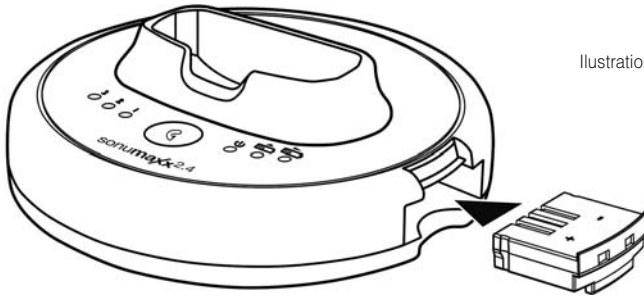

Illustration example: Underchin receiver



### Warning:

Batteries (battery pack or batteries installed) shall not be exposed to excessive heat such as sunshine, fire or the like. Never use another type of battery or non-rechargeable batteries to replace the rechargeable batteries supplied. When the headphones are not in use, move the switch to the OFF position to avoid damaging the batteries.

The batteries must always be fully charged before first use. An initial 3 hours charge is required to guarantee an acceptable service life for the rechargeable batteries. Always ensure that the headset receiver is switched to OFF position while the batteries are charging. Excessive sound pressure from earphones and headphones can cause hearing loss.

### Important:

This unit should be operated with the special rechargeable batteries only. When replacing the batteries or when disposing of the unit, always comply with applicable laws relating to the disposal of batteries. Please place them in a proper disposal container to ensure that they are eliminated safely and in an environmentally friendly way.

## Communication feature:

The sound of the transmission can be interrupted at any time, for example to talk to a person in the same room. Press the MIC-button of the receiver once. The receiver's inbuilt microphone will now register the surrounding sounds and amplifies them. The volume can be be adjusted with the volume control. To end this function, press the MIC-button once more - the previous transmission will now continue.



## Tone clarity:

### Tone adjustment

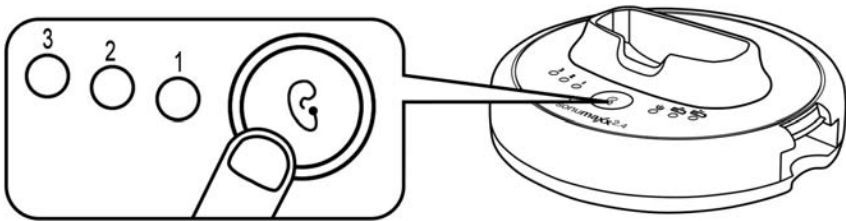
If required, the tone of the receiver can be adjusted. Press the Tone adjustment button to match your preference. The current setting is visible by the orange 1, 2 and 3 LEDs.

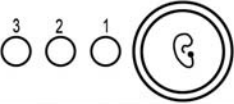
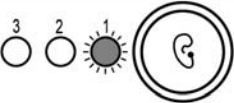
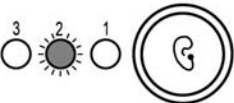

The tone / speech intelligibility can be enhanced individually on the transmitter with the following settings:

Setting	Orange LED-Indicator	Effect
Default		No Adjustment
1		Enhances Treble and Bass
2		Enhances Treble only
3		Enhances Bass only



## Troubleshooting:

### No sound:

- Ensure that the mains adapter is pushed fully into the power outlet and that its cable is properly connected to the DC IN connector on the transmitter.
- The charge level of the headset receiver battery may be too low. Recharge the battery or replace it with a fully charged battery.
- Ensure that the TV set, Hi-Fi system or audio component is switched ON and set to a channel that broadcasts an audio signal.
- Use the volume control on the Headset Receiver to increase the sound level.
- The connected audio/video equipment may not be in playback mode. Start playback on by the equipment.
- The Headset Receiver output level is set too low. Adjust the volume to a suitable level.

Pocket receiver only: Make sure that the plug of the neck loop is correctly inserted.

### Distortion:

- The charge level of the headset receiver battery may be too low. Recharge the battery or replace it with a fully charged battery.
- The headset receiver may be too far away from the transmitter. Move closer to it.
- The audio signal input level is too low. Increase the volume from the audio source.

**In case the receiver cannot be linked with the transmitter, please follow the following procedure for pairing :**

1. Disconnect the transmitter from the power supply.
2. Turn ON the headset receiver.
3. Hold the MIC-button pressed for approx. 5 seconds, the green LED on the receiver will start to blink rapidly. Immediately reconnect the power supply to the transmitter.
4. The receiver and the transmitter are hereby paired automatically, the steadily lit green LED on the receiver indicates successful pairing.

## Warranty

Should a malfunction occur despite the unit having been set up and operated correctly, please contact your dealer or the manufacturer directly.

This warranty covers the repair of the product and returning it to you free of charge. It is essential that you send in the product in its original packaging, so do not throw the packaging away.

The warranty does not apply to damage caused by incorrect handling or attempts to repair the unit by people not authorised to do so (destruction of the seal on the unit).

Repairs will only be carried out under warranty if the completed warranty card is returned accompanied by a copy of the dealer's invoice/till receipt.

**Always specify the product number in any event.**



**Disposal** of used electric and electronic units (applicable in the countries of the European Union and other European countries with a separate collection system). The symbol on the product or the packaging indicates that this product is not to be handled as ordinary domestic waste but has to be returned to a collection point for the recycling of electric and electronic units. You protect the environment and health of your fellow men by the correct disposal of this product. Environment and health are endangered by careless disposal. Material recycling helps to reduce the consumption of raw material. You will receive further information on the recycling of this product from your local community, your communal disposal company or your local dealer.

## Battery



The provided battery can be recycled. Please dispose the battery through the battery container or the specialist shop. Please dispose only discharged batteries to guarantee environmental protection.

## Specifications

Transmission mode:	Digital Hopping System
Carrier frequency:	2.4GHz ISM BAND I
Operating voltage: Transmitter :	5V 550mA
Receiver :	3.7 V, 350 mA Lithium Polymer Battery
Frequency response:	30 Hz – 20 KHz
Distortion:	<0.5%
Signal-to-noise ratio:	>75 dB
Range:	Up to 25 meters (open area)



This device complies to the following EU directives:

- 2011/ 65/EU RoHS Directive
- 2012/19/EU WEEE Directive
- 2014/53/EU R&TTE Directive
- EN 301 489-17 V3.1.1 : 2017
- EN 301 489-1 V2.1.1 : 2017
- EN 300 440 V2.1.1 : 2017
- EN 62479 : 2010
- 2014/35/EU Low Voltage Directive EN 60065 : 2014

Compliance with the directives listed above is confirmed by the CE seal on the device. CE compliance declarations are available on the Internet at [www.humantechnik.com](http://www.humantechnik.com).

Technical specifications subject to change without notice.