

SAFETY INSTRUCTIONS / PRECAUTIONS

The manufacturer cannot be held responsible for damage which is caused by not using the RF Modulator in compliance with the safety instructions or precautions.

- Do not open casing of the RF Modulator at any time, **NO** user serviceable parts can be found inside.
- Ensure mains power is disconnected **BEFORE** any connections are made to the Video Reader and RF Modulator. To switch off the Video Reader completely, you must disconnect it from the mains, the captions on/off button does **NOT** switch the mains power off.
- Do not expose the RF Modulator to rain or any other source of moisture.
- Do not place the RF Modulator close to sources of heat, such as radiators.

IF IN DOUBT SEEK EXPERT ADVICE

SECTION 'A' - Installation/Connections

- Refer to your *Video Reader*TM Owners Manual for initial installation / connection details.
- Place the *RF Modulator* in a convenient position behind your *Video Reader*TM.
- Your *RF Modulator* is supplied ready for use and comes complete with the connecting lead for connection to your *Video Reader*TM and an Aerial/RF coaxial lead for connection to your TV.

For ALL installations :

- Refer to your *Video Reader*TM Owners Manual.

As you do not have a SCART(AV) socket on your TV:

- Connect the RF Modulator connecting lead to the RF Modulator socket on the rear of your *Video Reader*TM
- Connect the RF/Aerial lead (supplied), pin end, into the Aerial socket of the TV.
- Connect the other end, socket end, of this lead into the 'RF out' socket on the *RF Modulator*.
- Connect your existing RF/Aerial lead, pin end, to the 'RF in' socket on the *RF Modulator*.
- Connect the other end, socket end, of this lead into the 'RF out' socket of the video recorder.

- **DOUBLE CHECK ALL CONNECTIONS.**

- Switch on the mains supply to the *Video Reader*TM, TV and video recorder.

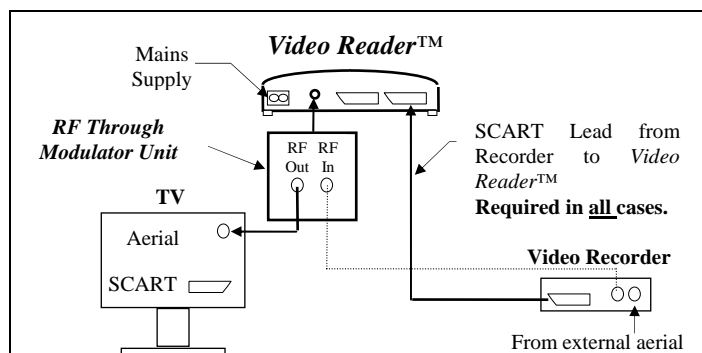

Rear View of *Video Reader*TM and *RF Through Modulator*

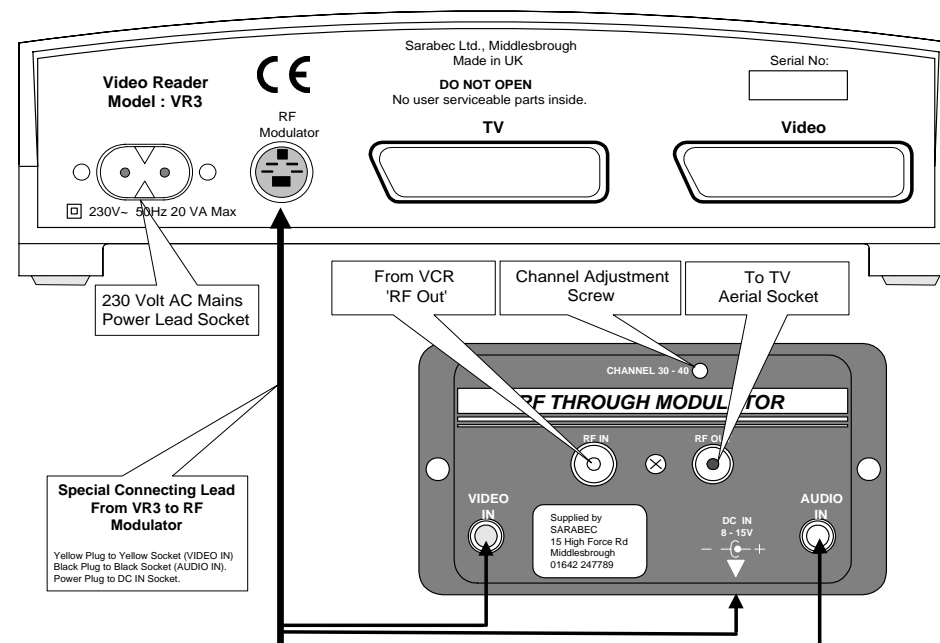

SECTION 'B' - Tuning In Television

As you are using the RF Modulator option:

- You will need to tune your TV in the same way as you did when tuning in for standard TV channels and your video recorder.
- The RF Modulator output is pre-set for channel 38, *please ensure that this channel is different to the channel of your video recorder.*
- Select a spare channel on the TV (**NOT** your normal Video channel), e.g. 6 or 7.
- Play a pre recorded **Closed Captioned Tape** and Tune the TV until you see a captioned picture on the screen. (on some TVs you may need to store the selected channel after tuning, refer to your TV manual).

SECTION 'C' - Playing a Closed Captioned Video

You are now ready to watch a closed captioned video.

- Please refer to your *Video Reader*TM Owners Manual for instructions on playing closed captioned video's.

SECTION 'D' - Problems and Cures

Problem	Cure
Captions not visible	<ul style="list-style-type: none">• Re-check all connections.• When using RF Modulator & Aerial lead to TV, check tuning.• Use a compatible "□" video cassette.• Try another compatible "□" video cassette.

If in doubt please contact your dealer for assistance.

SECTION 'E' - Specification

Input connections	<ul style="list-style-type: none">• Via special AV / power lead with 4 pin DIN plug (Supplied) for direct connection to <i>Video Reader</i>TM RF Modulator socket.• RF / Coaxial socket (Labelled: RF In) for connection to a VCR RF Out socket via coaxial lead.
Output connections	<ul style="list-style-type: none">• RF / Coaxial socket (Labelled: RF Out) for connection to a TV RF (aerial) socket via coaxial lead.
Controls	<ul style="list-style-type: none">• RF Modulator Channel 30-40 adjustment screw.



Product conforms to the provisions of the following European Union Directives :

- 89/336 & 92/31 Electro Magnetic Compatibility Directives
- 93/68 CE Marking Directive



SarabeC)))))[®]

RF Through Modulator

Model (PAL - I)

For VR3 *Video Reader*TM

Owner's Manual

Introduction

Some older Televisions are not equipped with Audio Visual (AV) sockets to enable other equipment to be connected directly, therefore Sarabec's RF Modulator unit allows owners of older Television sets to enjoy the benefits of closed captioned films with a simple low cost solution.

Simply plug the RF Modulator into your *Video Reader*TM, with the special lead provided, tune your TV following the instructions provided and that's it...!!!

Please refer to your *Video Reader*TM Owners Manual for further information on installing and connecting the *Video Reader*TM and playing closed captioned videos.

Before operating the unit, please read this leaflet thoroughly and retain it for future reference.

Happy viewing!

SarabeC))))) and *Video Reader* are marks of Sarabec Ltd. □ is a mark of National Captioning Institute Inc.

© Sarabec Ltd 133-351.002 1098 VR3 RF Modulator.doc

Sarabec Limited 15 High Force Road Middlesbrough TS2 1RH UK
Telephone (01642) 247789 Fax (01642) 230827 Text (01642) 251310